

it's about the

*Experience*



**AVIDA** **ESPERANCE**



## Key Features

- Rear wheel drive
- Large slide out
- Washer / Dryer
- Tow Bar
- Driver & Passenger arm rests
- Front swivel seats
- Diesel heater
- 2 x Smart TVs
- Solar
- LED rear taillights
- External BBQ storage
- Upholstered dinette & bed base
- Soft close drawers
- Handle free overhead cupboards
- Reverse cycle A/C

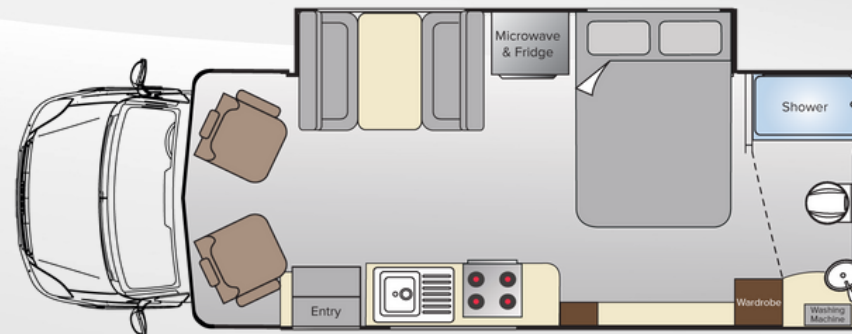

B7832SL

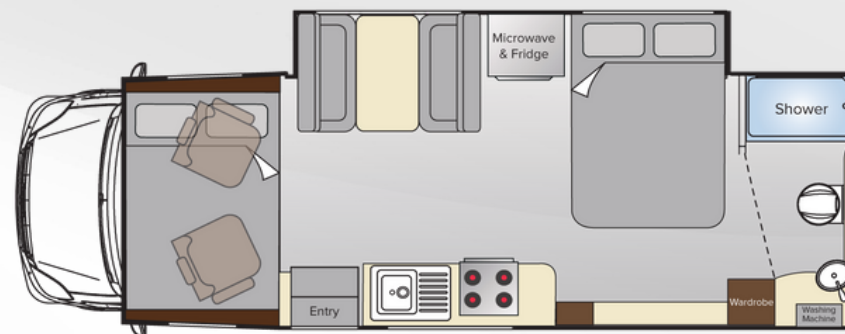

C7834SL

## Specifications

Exterior Height	B & C Type - 3200mm
Exterior Width	2495mm
Exterior Length	7850mm
Interior Height	2015mm
Fresh Water	175ltr
Grey Water	100ltr
Black Water	19ltr
Chassis Type	Iveco
Engine	4 cylinder turbo diesel
Output Power	132kw (180hp) @ 3500rpm
Torque	430Nm @ 1500rpm
Transmission	Auto
GVM	5200kg
Licence	Light Rigid
Towing Capacity	3500kg



## WHAT OUR CUSTOMERS HAVE TO SAY

So so pleased with this top class motorhome - quality workmanship at its best. Travel is like "home away from home".

*- Robyn, Tannum Sands Qld*

My Esperance is a pleasure to drive and easy to park. There is heaps of storage and it is so easy to setup. Auto levelling was a great investment. It is so well appointed inside and the finish of cupboards and appliances is impeccable. I could not be happier.

*- ' Karl, Launceston Tas*

Ever since we started looking at motorhomes, we loved the Esperance and now we own one. We love the layout and the sense of space that it gives us. Being able to support Australian made is awesome too.

*- John, Yarramundi NSW*

I think it's fantastic value for money and I love the layout. I am very happy with it.

*- Max, Auckland NZ*

Avida is a family owned business and has been manufacturing RVs in Australia since 1965. The Esperance range launched in 2009 as the Winnebago Esperance and today the Avida Esperance is built using Avida's unique sandwich panel construction with a one-piece floor, walls and roof. You can view the Avida Esperance with a large slide out at your local Avida dealer, or take a virtual 3D tour on the Avida website.

## AVIDA'S UNIQUE SANDWICH PANEL CONSTRUCTION:

- U**pstanding • Walls fixed to the top of the floor, not the side
- N**otable • One piece floor, walls & roof construction
- I**mpressive • Strong enough to walk on the roof
- Q**uality • Long lasting easy to clean surfaces
- U**nbreakable • Dent & hail resistant fibreglass finish
- E**nvironment • High insulation rating

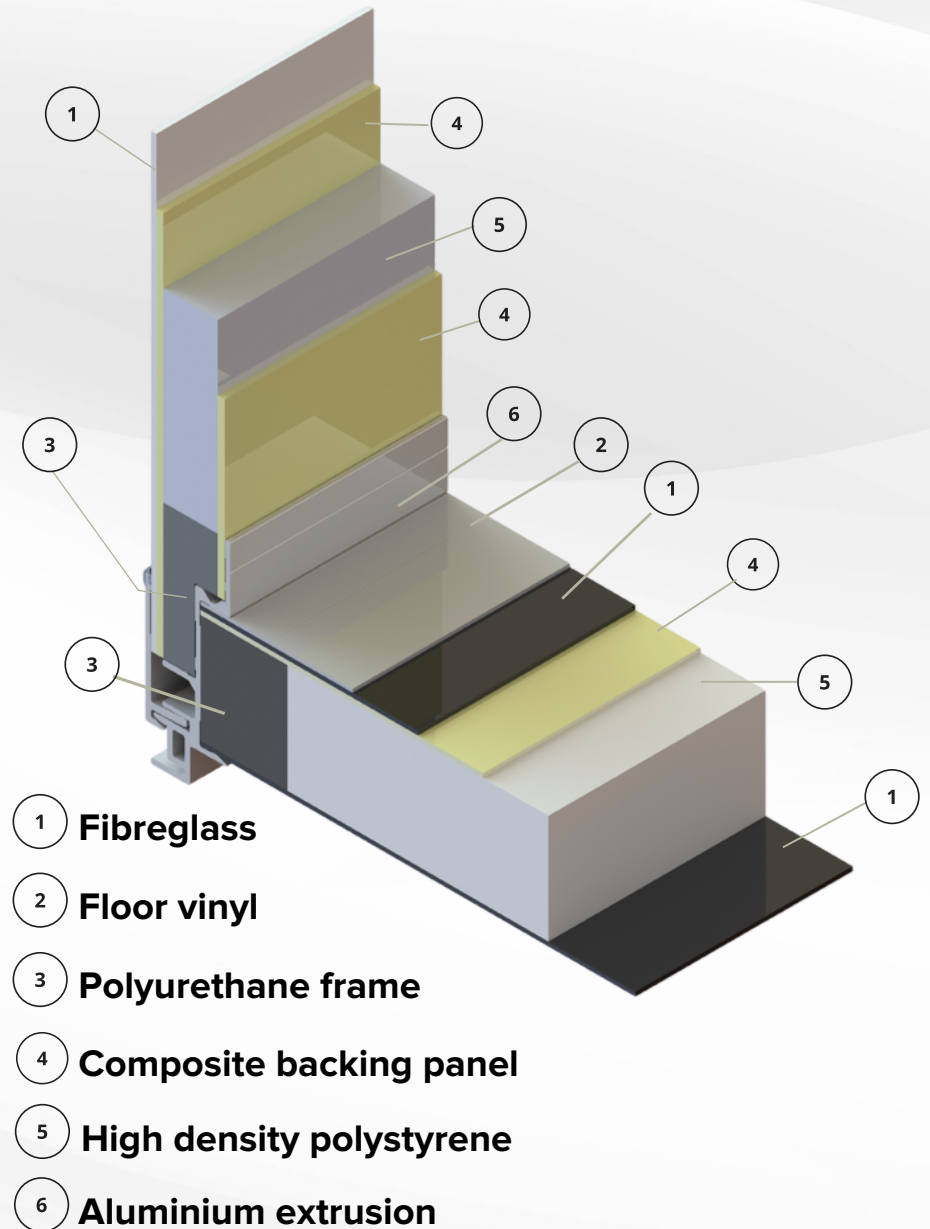

## **AVIDA** WARRANTY

- 3 years factory warranty
- 5 year structural guarantee
- Efficient spare parts turnaround

## **AVIDA** SUPPORT

- Factory trained Dealer Network
- Over 100 accredited service locations
- Australia and New Zealand

## **AVIDA** RV HELP

- Free for 2 years with new Avida purchase
- 24 hours a days/7 days a week / 365 days a year
- No weight, length or height restrictions
- Nationwide coverage

## **AVIDA** FACTORY TOUR

Visit our modern manufacturing facility at Emu Plains, west of Sydney where you can enjoy a guided factory tour held on Fridays by APPOINTMENT ONLY. Please note, tour numbers are limited.

## **AVIDA** EXPERIENCE HUB

[www.experience.avidarv.com.au](http://www.experience.avidarv.com.au)

Enhance your RV lifestyle with our Experience Hub exclusive to Avida Owners.

- Access vehicle information
- How to videos
- Owners manuals
- Follow the journey of your order
- Purchase/renew RV Help
- Book a service
- Discounts
- Road trips
- Events
- Online parts store



## **AVIDA** INDUSTRY ACCREDITED

RVMAP, Australia's Caravan Industry accreditation program requires all RVs produced by members to comply fully with all safety regulations, including Australian Design Rules and Australian Standards.



**DISCOVER** your dreams at [www.avidarv.com.au](http://www.avidarv.com.au)

 **AVIDA** Motorhomes & Caravans

Please read: Due to continuous improvement, specifications are subject to change without notice. For more detailed information please contact your nearest Avida Dealer on 1300 4 AVIDA (28432). 2022-5

it's about the

*Experience*

